

## PREMISES LICENCE

**Premises Licence Number**

R&BBC 22/01042/LAPREM

### Part 1 – Premises Details

**Postal address of premises, or if none, ordnance survey map reference or description, including Post Town, Post Code**

Gigging Squid  
 65 High Street  
 Reigate  
 Surrey  
 RH2 9AE

**Telephone number** 02034002326

**Where the licence is time limited the dates**

-

**Licensable activities authorised by the licence**

The Supply of Alcohol  
 Late Night Refreshment

**Times the licence authorises the carrying out of licensable activities**

The Supply of Alcohol	
Every Day	09:00 - 23:30
Late Night Refreshment	
Every Day	23:00 - 00:00

**The opening hours of the premises**

Every Day 09:00 - 00:00

**Where the licence authorises supplies of alcohol whether these are on and / or off supplies**

Alcohol is supplied for consumption both on and off the Premises

**Licence Granted : 13<sup>th</sup> October 2011**

**Part 2**

**Name, (registered) address, telephone number and email (where relevant) of holder of premises licence**

Chokdee Ltd  
Unit 2  
The Billings  
Walnut Tree Close  
Guildford  
GU1 4UL

Applicants Electronic Mail                      craig.baylis@bcplaw.com

**Registered number of holder, for example company number, charity number (where applicable)**

Registered Business Number                      04508336

**Name, address and telephone number of designated premises supervisor where the premises licence authorises for the supply of alcohol**

Pavol Klar

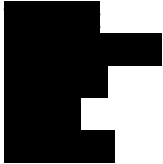

**Personal licence number and issuing authority of personal licence held by designated premises supervisor where the premises licence authorises for the supply of alcohol**

Personal licence reference: LN/000003192

Local Authority: Waverley Borough Council

## **Annex 1 – Mandatory conditions**

### **1. All supplies of alcohol**

"No supply of alcohol may be made under this licence

- a. At a time when there is no designated premises supervisor in respect of it or,
- b. At a time when the designated premises supervisor does not hold a personal licence or his personal licence is suspended"

"Every retail sale or supply of alcohol made under this licence must be made or authorised by a person who holds a personal licence."

### **2. Door Supervisors**

Only individuals licensed by the Security Industry Authority may be used at the premises to guard against:-

- a. unauthorised access or occupation (e.g. through door supervision), or
- b. outbreaks of disorder, or
- c. damage

NB This condition will only be imposed where the premises licence contains a condition that at specified times one or more individuals must be at premises to carry out the activities specified in the above condition. The condition is not mandatory in respect of premises:-

- \* with premises licences authorising the performance of plays or films
- \* being used exclusively by a club with a club premises certificate
- \* under a TEN authorising plays or films
- \* under a gaming licence .(but see Licensing Act S21(2)(b))
- \* being used for an occasion prescribed by regulations under the SIA.

### **3. Irresponsible Promotions**

1. (1) The responsible person must ensure that staff on relevant premises do not carry out, arrange or participate in any irresponsible promotions in relation to the premises.

(2) In this paragraph, an irresponsible promotion means any one or more of the following activities, or substantially similar activities, carried on for the purpose of encouraging the sale or supply of alcohol for consumption on the premises—

(a) games or other activities which require or encourage, or are designed to require or encourage, individuals to—

(i) drink a quantity of alcohol within a time limit (other than to drink alcohol sold or supplied on the premises before the cessation of the period in which the responsible person is authorised to sell or supply alcohol), or

(ii) drink as much alcohol as possible (whether within a time limit or otherwise);

(b) provision of unlimited or unspecified quantities of alcohol free or for a fixed or discounted fee to the public or to a group defined by a particular characteristic in a manner which carries a significant risk of undermining a licensing objective;

(c) provision of free or discounted alcohol or any other thing as a prize to encourage or reward the purchase and consumption of alcohol over a period of 24 hours or less in a manner which carries a significant risk of undermining a licensing objective;

(d) selling or supplying alcohol in association with promotional posters or flyers on, or in the vicinity of, the premises which can reasonably be considered to condone, encourage or glamorise anti-social behaviour or to refer to the effects of drunkenness in any favourable manner;

(e) dispensing alcohol directly by one person into the mouth of another (other than where that other person is unable to drink without assistance by reason of disability).

2. The responsible person must ensure that free potable water is provided on request to customers where it is reasonably available.

#### 4. Age verification policy

- (1) The premises licence holder or club premises certificate holder must ensure that an age verification policy is adopted in respect of the premises in relation to the sale or supply of alcohol.
- (2) The designated premises supervisor in relation to the premises licence must ensure that the supply of alcohol at the premises is carried on in accordance with the age verification policy.
- (3) The policy must require individuals who appear to the responsible person to be under 18 years of age (or such older age as may be specified in the policy) to produce on request, before being served alcohol, identification bearing their photograph, date of birth and either?
  - (a) a holographic mark, or
  - (b) an ultraviolet feature.

#### 5. Alcoholic drink measures

- (a) where any of the following alcoholic drinks is sold or supplied for consumption on the premises (other than alcoholic drinks sold or supplied having been made up in advance ready for sale or supply in a securely closed container) it is available to customers in the following measures—
- (i) beer or cider: ½ pint;
  - (ii) gin, rum, vodka or whisky: 25 ml or 35 ml; and
  - (iii) still wine in a glass: 125 ml;
- (b) these measures are displayed in a menu, price list or other printed material which is available to customers on the premises; and
- (c) where a customer does not in relation to a sale of alcohol specify the quantity of alcohol to be sold, the customer is made aware that these measures are available."

#### 6. Permitted price

1. A relevant person shall ensure that no alcohol is sold or supplied for consumption on or off the premises for a price which is less than the permitted price.
2. For the purposes of the condition set out in paragraph 1—
  - (a) "duty" is to be construed in accordance with the Alcoholic Liquor Duties Act 1979;
  - (b) "permitted price" is the price found by applying the formula—

$$P = D + (D \times V)$$

where—

- (i) P is the permitted price,
  - (ii) D is the rate of duty chargeable in relation to the alcohol as if the duty were charged on the date of the sale or supply of the alcohol, and
  - (iii) V is the rate of value added tax chargeable in relation to the alcohol as if the value added tax were charged on the date of the sale or supply of the alcohol;
- (c) "relevant person" means, in relation to premises in respect of which there is in force a premises licence—
- (i) the holder of the premises licence,
  - (ii) the designated premises supervisor (if any) in respect of such a licence, or
  - (iii) the personal licence holder who makes or authorises a supply of alcohol under such a licence;
- (d) "relevant person" means, in relation to premises in respect of which there is in force a club premises certificate, any member or officer of the club present on the premises in a capacity which enables the member or officer to prevent the supply in question; and

(e) "valued added tax" means value added tax charged in accordance with the Value Added Tax Act 1994.

3. Where the permitted price given by Paragraph (b) of paragraph 2 would (apart from this paragraph) not be a whole number of pennies, the price given by that sub-paragraph shall be taken to be the price actually given by that sub-paragraph rounded up to the nearest penny.

4. (1) Sub-paragraph (2) applies where the permitted price given by Paragraph (b) of paragraph 2 on a day ("the first day") would be different from the permitted price on the next day ("the second day") as a result of a change to the rate of duty or value added tax.

(2) The permitted price which would apply on the first day applies to sales or supplies of alcohol which take place before the expiry of the period of 14 days beginning on the second day.

## **Annex 2 – Conditions consistent with the Operating Schedule**

An established company run by the applicant who will continue to take an active part in its operation ensuring that good training is in place especially in relation to underage sales and refusals of service. All training will be recorded, and records made available to the officers of the licensing authority and police.

Digital CCTV and appropriate recording equipment is installed, operated and maintained throughout the premises internally to cover all public areas with sufficient numbers of cameras. CCTV footage will be stored for a minimum of 28 days, and the management will give full and immediate co-operation and technical assistance to the Police in the event that CCTV footage is requested for the prevention and detection of suspected or alleged crime. The CCTV images will record and display dates and times, and these times will be checked regularly to ensure their accuracy and will be changed when British Summertime starts and ends.

The CCTV will be signed off by a Police Officer from the Police Licensing Unit to say it meets the required specifications.

Alcohol will only be served to customers who are also having or have had a table meal at the premises.

A new fire risk assessment will be carried out and training as required given to all staff.

There is no regulated entertainment, however service to the outside area at the front of the premises if granted the Highways Licence will cease at 2200.

Notices will be displayed asking patrons to leave quietly and respect the neighbours.

A family friendly restaurant into which children will be admitted as is allowed by licensing law. The premises will adopt a "Challenge 25" policy whereby any person attempting to buy alcohol who appears to be under 25 will be asked for photographic ID as proof of their age. The only ID that will be accepted are passports, UK driving licences or other recognised National ID documents as detailed in licensing policy all bearing date of birth and a photograph or proof of age cards bearing the "PASS" mark hologram. The list of approved ID may be amended or revised in line with Licensing Policy without the need to amend the actual licence.

A refusal register will be maintained by the staff and all cases of refusing service for age related sales and other offences will be recorded. The register will be inspected by the DPS regularly and signed at least once a month to say it has and will be available for inspection by officers of the licensing authority and the Police.

The rear gardens can be used to serve no more than 16 patrons at one time. The latest time that patrons can be seated in the rear garden is 17:00. The latest time that a food order can be made in the rear garden is at 17:30. Alcohol only to be served in the rear garden until 18:30. The rear garden area will be cleared by patrons by 19:00.

Thereafter the area to be used only for emergency purposes and doors and windows to be kept shut after 19:00. These conditions are valid until 21 September 2021.

After 21 September 2021, there is no public access to the rear gardens except in emergency and doors and windows of the premises will be kept shut after 23:00 except for passing through.

### **Annex 3 – Conditions attached after a hearing by the licensing authority**

1. All rear windows are to be kept closed except for the first-floor bay windows, these to be under management control and to close no later than 2300 hrs
2. Bottle bins stored outside will not contain empty bottles. Any bottle bin which is being used for the purpose of collecting or storing empty bottles will be kept inside.
3. There will be no use of the rear garden by staff after 19:00.
4. The back gate is not to be used as a normal point of access or egress.
5. There will be no smoking allowed in the rear garden at any time.
6. There will be a member of staff present at all times, to supervise the use of the area and to ensure that any noise is kept to a minimum, whilst patrons are seated in the rear garden.
7. The premises licence holder will ensure that the details of a dedicated telephone line is made available to local residents.





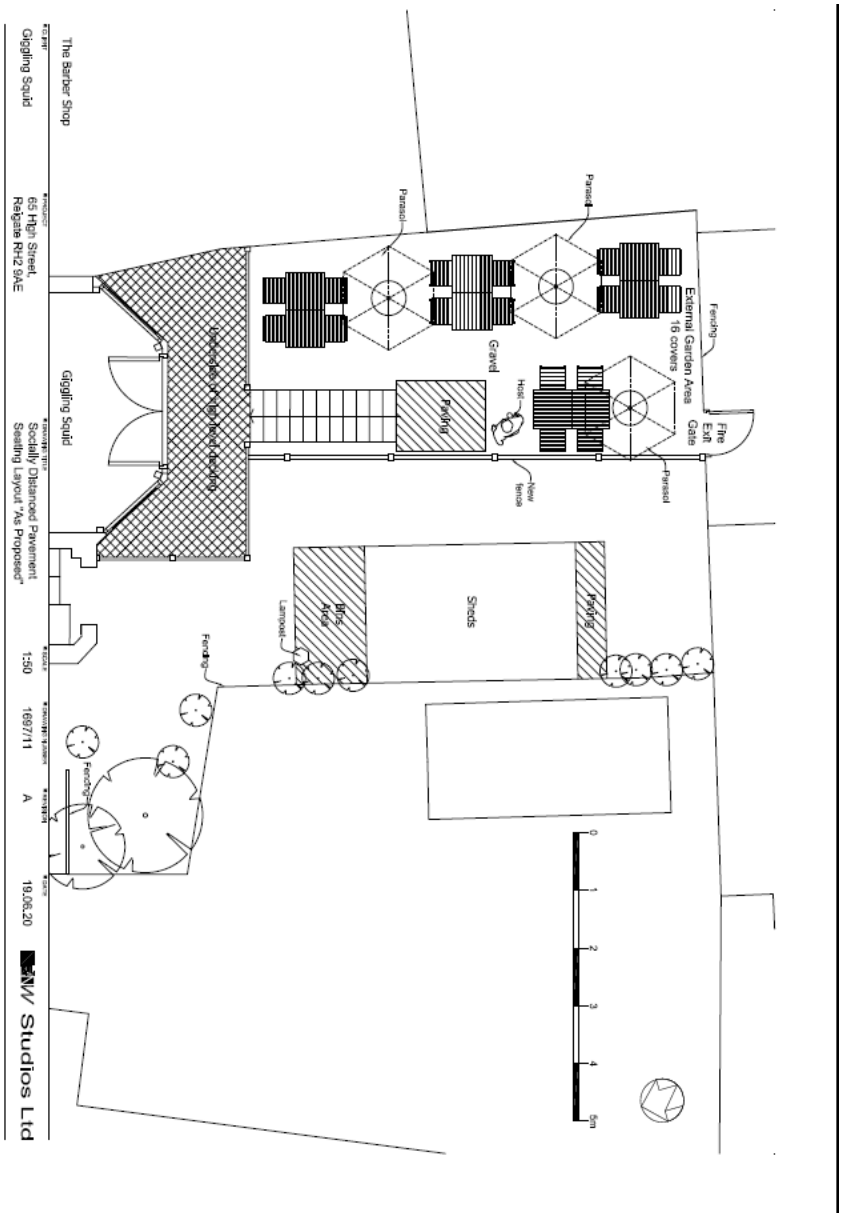

The Barber Shop

65 High Street,  
Regina RH2 5AE

Socially Distant Pavement  
Sealing Layout "As Proposed"

1:50

1687/11 A

19.06.20

Studio Studios Ltd